

# BNN

## FEATURES

- Accuracy guaranteed to 0.003mm TIR (0.0001")
- Excellent for CNC and conventional machines.
- Draw-off nut type. (Help to easy release from tail-stock.)
- Heat-treated point to HRc 60 ± 2.
- High performance lip seal and deflected shaft design protects bearing space (Double Angular Contact Bearing) from ingress by dust and coolant.
- Heat-treated body for extra strength, rigidity and long life.
- Carbide point available.
- Carbide point to HRa 90 ± 5.

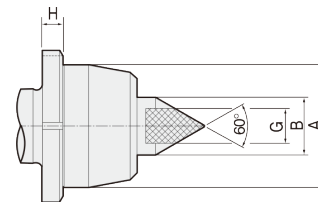
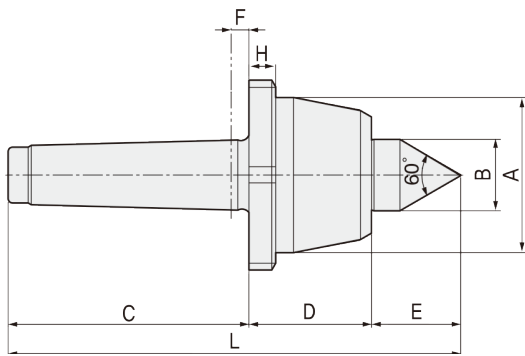

### Available Carbide Tipped Points BNNC-TYPE

- MT2: 022002
- MT3: 022003
- MT4: 022004
- MT5: 022005
- MT6: 022006

## Dimension

Unit: mm. kg

MODEL	MT	A	B	C	D	E	F	H	G	L	Workpiece Weight	Max, R.P.M	Weight	Max, Run Out	AN NUT NO.
021002 (022002)	2	50	25	68	43.5	29.5	6	10	10	141	500	5,000	1	0.003	AN09
021003 (022003)	3	50	25	85	43.5	29.5	6	10	10	158	500	5,000	1	0.003	AN09
021004 (022004)	4	69	32	108	55	40	8	12	14	203	800	3,800	2.1	0.003	AN13
021005 (022005)	5	88	40	136	70	50.5	8	16	18	256.5	2,000	3,000	5	0.003	AN17
021006 (022006)	6	105	50	189	81.5	57.5	10	18	30	328	3,500	2,800	10.5	0.005	AN20

\* (MODEL NO) : Carbide Tip Type

## BNN type Technical data

- 2,3BNN
- 4BNN
- 5BNN
- 6BNN

