

# BS

## FEATURES

- Accuracy guaranteed to 0.002mm TIR (0.0001")
- Excellent for CNC, grinder and high speed light-duty machining.
- High RPM (Up to 6,000)
- Heat-treated point to HRc 60 ± 2.
- Based on double angular contact bearings for superior performance.
- Anti-friction seal for coolant deflectors and high speed.
- Heat-treated body for extra strength, rigidity and long life.
- Carbide point available.
- Carbide point to HRa 90 ± 5.

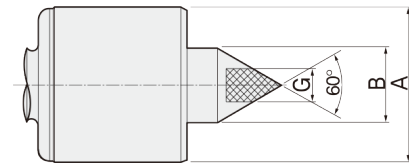
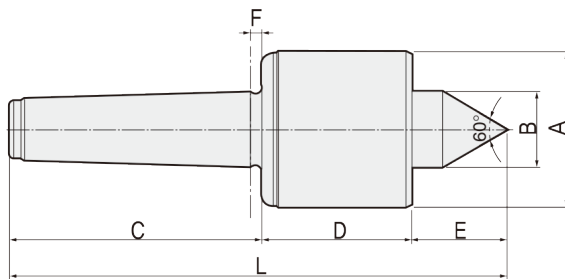

Available Carbide Tipped Points

**BSC-TYPE**

- MT3: 162003
- MT4: 162004
- MT5: 162005

## Dimension

Unit: mm. kg

MODEL	MT	A	B	C	D	E	F	G	L	Workpiece Weight	Max, R.P.M	Weight	Max, Run Out
161003 (162003)	3	50	20	85	58	23	4.5	10	166	750	6,000	1.9	0.002
161004 (162004)	4	66	31	107	71	33.5	5.3	14	211.5	1,300	6,000	2.4	0.002
161005 (162005)	5	80	35	136	78	38	6.3	18	252	2,000	5,000	5.3	0.002

\* (MODEL NO) : Carbide Tip Type

## BS type Technical data

- 3BS
- 4BS
- 5BS

